

Grande Cache Camp Hide-A-Way

P.O. Box 300, Grande Cache, Ab. T0E 0Y0
Phone: 780.827.3300 tourism@grandecache.ca



To Grande Cache
hwy 40 north

Welcome 

To Hinton
hwy 40 south

Toilet



Group
Fire Pit



Supply Shed

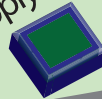

Cabin: Ask-A-Way
7

Cabin: Ross-A-Way
2

Cabin: Bob's-A-Way
3

Cabin: Wally-A-Way
4

Cabin: Den-A-Way
5

Cabin: Cache-A-Way
6

Parking



Fire
Wood



Main Lodge

Park Area

Supply Shed



Toilet

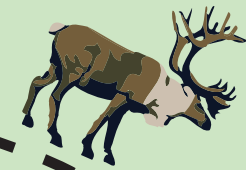

To Hiking &
Cross Country Ski Trails



To Pierre Grey's Lakes
Provincial Recreation Area



Camp Hide-A-Way: Information & Policies

Rates

➤ Exclusive Use of Cabins & Main Lodge

1 Night: \$400.00

2 or more: \$350.00 per night

➤ Non-Profit Organizations/Clubs/Groups

1 Night: \$200.00

2 or more: \$175.00 per night

➤ Exclusive use of one sleeping cabin, with access to Main Lodge:

Per Night: \$75.00

➤ Daily use of Main Lodge:

Daily: \$175.00

- Deposit = 1st night's rental. (Credit cards, certified cheques or money orders)
- Cancellations received at least 14 days prior to check-in date will be charged a \$20.00 cancellation fee.
- Bookings, cancellations and/or date alterations less than 2 weeks prior to check-in date, will result in being charged for the entire stay, unless the facility can be rebooked.

Procedure

- Deposit is taken at Tourism Centre at time of booking and will confirm booking
- Information package with waiver is sent via email or post
- Renter will pay the remainder at the Tourism Centre and damage deposit before checking in to the camp. A confirmation number will be given, which will then be given with the signed waiver, to Dennis the caretaker..
- Check in time: After 2 p.m. Check out time: 12 p.m.
- If there is damage or excessive cleanup, the caretaker will issue a report. The amount will be deducted from the deposit and additional fees be applied to your credit card, if deemed necessary.

Basic Info

- **Main Lodge** - Day use only. Maximum – 60 people. 2 stoves, 2 fridges, flush toilets and showers. Wood stove, furnace and cell phone accessibility
- **Cabins** - 6 available. Electrical heat. Each building has 4 single & 2 double beds
- **Wheelchair Access** - #1 & 2 cabins & Main Lodge have ramps
- **RV's & Campers** - Maximum – 2. These vehicles are considered an extra use of the facility and are \$20/vehicle, per night. They are only allowed between the Main Lodge and entrance gate. There are no plugins, gas barbeques or sewer dump on site.
- **ATV's** - No riding of all-terrain vehicles (quads, etc...) is allowed on the trails and road that are a part of Pierre Grey's Lakes Recreation area.
- **Pets** - Must be kept on a leash at all times. Pets aren't allowed in the cabins or Lodge.

***Liability for loss or damage to personal property or personal injury while on Hide-A-Way property is solely the responsibility of occupant and guests.**

***Failure to observe the above rules may be grounds for eviction.**
